

# GLOBAL88

CITY CENTRE

SECTOR 88A GURUGRAM



HARERA LICENCE NO. 07 OF 2022

Elevate your Business...

A PROJECT BY

**BREEZ**  
BUILDERS & DEVELOPERS



Disclaimer:- The drawings and graphics apart from actual images, given in this brochure is for preliminary purposes.  
Further the Promoter/Architect reserves the right to add / delete specifications mentioned, if so warranted by the circumstances.

## CORPORATE OFFICE

UNIT NO. 903-905, C-WING, JMD MEGAPOLIS  
SOHNA ROAD, GURUGRAM - 122018

## CONNECT WITH US

PH. +91 - 7290 858 585 ( CORPORATE SALES )

EMAIL | GH88A@BREEZBUILDERS.COM





AT BREEZ WE ARE,  
NOT JUST CREATING  
HOMES BUT CREATING  
A DESTINATION.

Over the years we have developed a keen understanding of people, their values, expectations of a home and all that goes into creating a world of special experiences that they will cherish.

With a successful background that goes back a decade, our business is poised to set its sights even higher. Beginning with achieving new milestones in a diverse set of projects through Gurugram, Haryana, we only plan to fly higher. Persistent long term planning, thinking out-of-the-box and unquestionable service has set us apart, not just as a company you work with but as a community you can bank on.

We look forward to helping you achieve a smooth and easy transition into the field of real estate.



Department of Town & Country Planning  
**CERTIFICATE OF RECOGNITION**  
On-Time Delivery of Affordable Housing Project

Award Presented By  
Sh. Manohar Lal Khattar  
Hon'ble Chief Minister Haryana

100%  
ON TIME COMPLETION  
SUCCESSFULLY  
DELIVERED PROJECTS

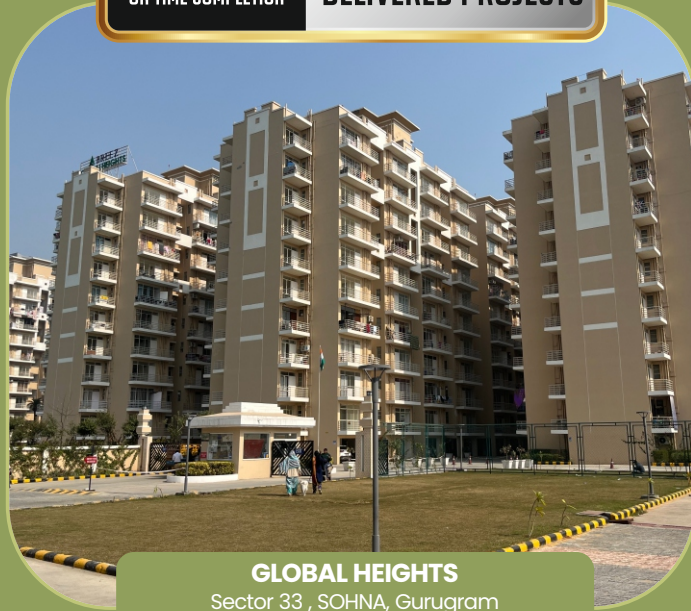

**PARTNERING WITH THE BEST**

With a host of ambitious projects rapidly taking shape, today ‘BREEZ’ as a brand stands at the threshold of bringing in more landmarks and more innovative concepts of home, retail and business. The future beckons and Brand ‘BREEZ’ is ready for it

COMMERCIAL & RESIDENTIAL  
PROJECTS UNDER CONSTRUCTION

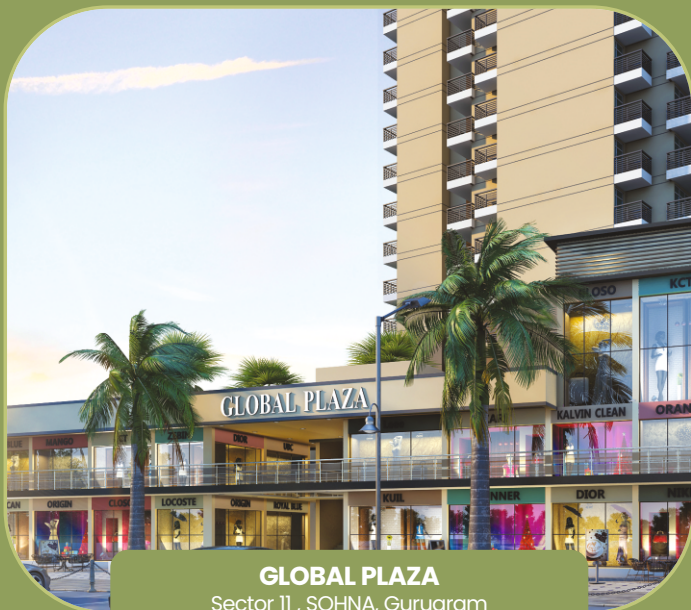
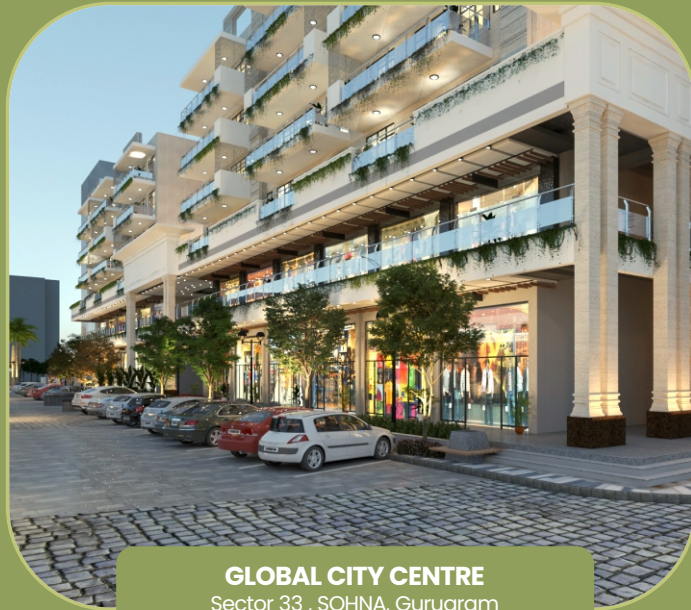

# High-street Retail Experience

**Modern architecture marries upscale designs to create a holistic environment, ensuring that you are still in the lap of nature while simultaneously enjoying a modern lifestyle**

A rare business opportunity poised to reap long-term profits and commercial success because of its coveted location, brilliant designs and smartly conceived amenities.

Yes, you read it right! Global City Centre 88A is the happening business destination coming up in the buzzing area of sector 88A, Gurugram. With magnificent glass facade that makes an imposing style statement, Infinity plaza presents you an excellent range of retail shops that enjoy best of location and facilities for your business.

**Shops & Retail Spaces Empowering Ambitions to become a successful reality**

**A profitable business destination, sector 88A Gurugram**

## THE WINNING LOCATION

- Proximity to the planned Metro Station.
- Dwarka Expressway just few meters away( walking distance ).
- Connected by 3 National Highways: Delhi-Jaipur Highway (NH 48), Dwarka Expressway(NH 248BB) & Pataudi Road (NH 352W)
- Emerging as one of the prominent destinations for IT/ITeS companies.



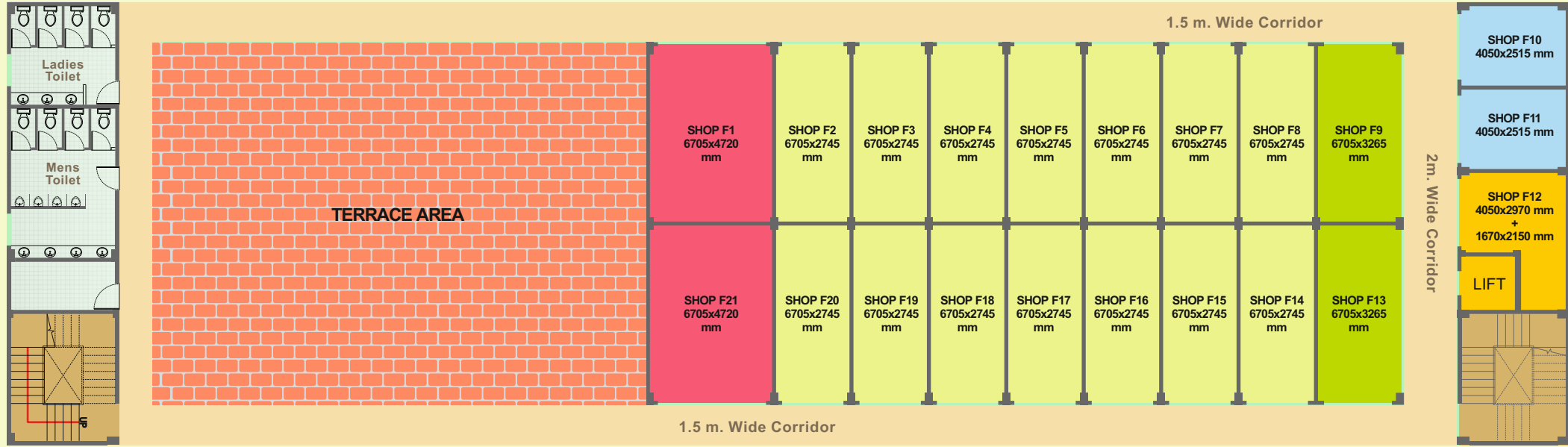

<div></div> Shop Saleable Area: 464.06 Sq.Ft Shop Size: 6705 x 3265 mm	<div></div> Shop Saleable Area: 258.94 Sq.Ft Shop Size: 4050 x 2515 mm	<div></div> Shop Saleable Area: 396.22 Sq.Ft Shop Size: 6705 x 2745 mm	<div></div> Shop Saleable Area: 336.24 Sq.Ft Shop Size: (4050x2970mm + 1670x2150mm)	<div></div> Shop Saleable Area: 681.30 Sq.Ft Shop Size: 6705 x 4720 mm
---	---	---	--	---

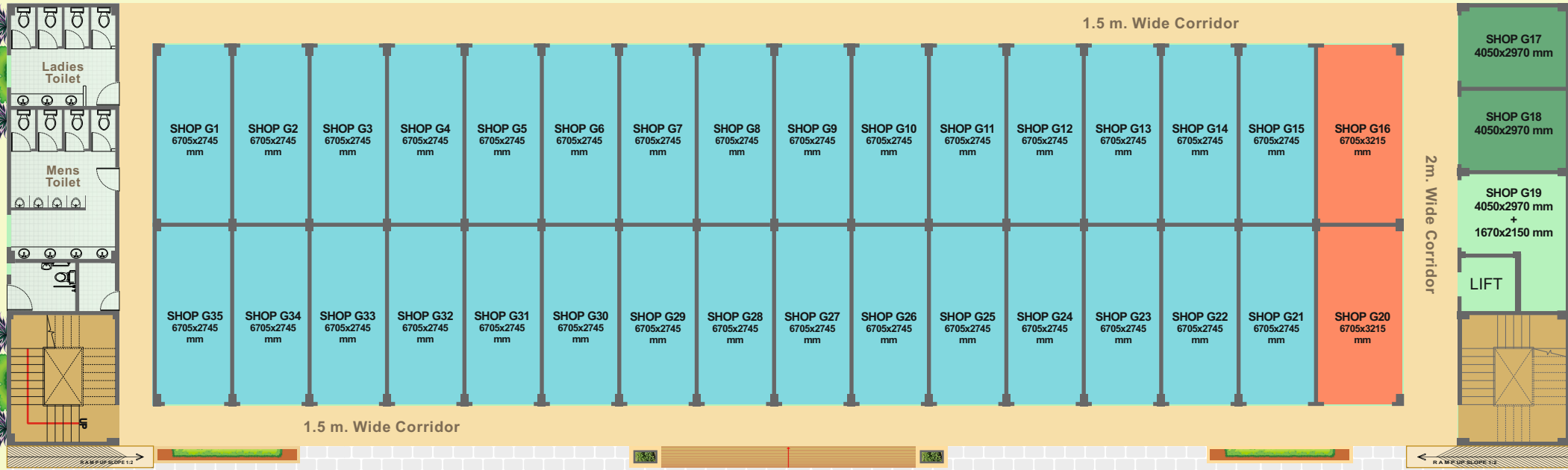

<div></div> Shop Saleable Area: 336.24 Sq.Ft Shop Size: (4050x2970mm + 1670x2150mm)	<div></div> Shop Saleable Area: 258.94 Sq.Ft Shop Size: 4050 x 2970 mm	<div></div> Shop Saleable Area: 464.06 Sq.Ft Shop Size: 6705 x 3215 mm	<div></div> Shop Saleable Area: 396.22 Sq.Ft Shop Size: 6705 x 2745 mm
--	---	---	---

## GROUND FLOOR PLAN COMMERCIAL - 2

Global City Centre 88A

<div></div> Shop Saleable Area: 482.82 Sq.Ft Shop Size: 6655 x 3365 mm	<div></div> Shop Saleable Area: 393.26 Sq.Ft Shop Size: 6655 x 2745 mm	<div></div> Shop Saleable Area: 241.05 Sq.Ft Shop Size: 6655 x 3370 mm
---	---	---

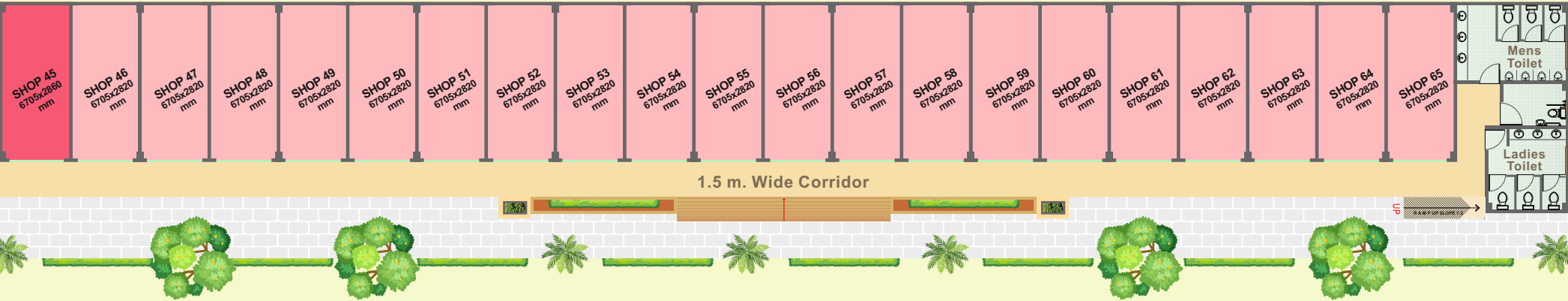
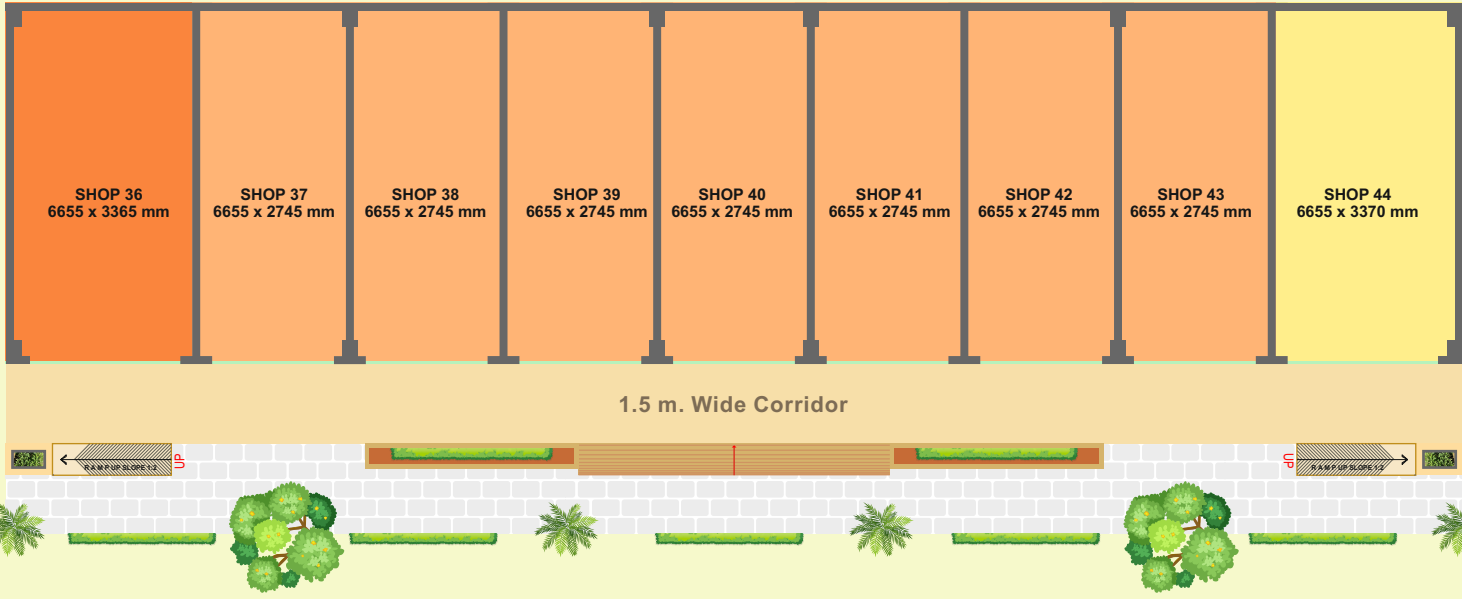

<div></div> Shop Saleable Area: 412.82 Sq.Ft Shop Size: 6705 x 2860 mm	<div></div> Shop Saleable Area: 407.06 Sq.Ft Shop Size: 6705 x 2820 mm
---	---

Disclaimer:- The drawings and graphics apart from actual images, given in this brochure is for preliminary purposes. Further the Promoter/Architect reserves the right to add / delete specifications mentioned, if so warranted by the circumstances.

# GLOBAL CITY CENTER UNIQUE BENEFITS

## Convinient. Classy. Commercial

- Effective planning allows street level entrance overlooking pedestrian walkway all around the complex
- Shops for International Style retail format with independent service utilities
- The project is surrounded by high dense residential sectors
- Provision of Wet Points in all Units
- The complex is under construction and floor-wise lease/sale options are available
- Independent shops with low maintenance module & excellent returns
- Shop modules offer flexibility in sizes – each block can be combined together if desired

# A HOST OF FACILITIES FOR SMOOTH BUSINESS OPERATIONS

## Design Specifications

- Large store fronts & glazing area for units
- Exterior: Combination of glass, marble, stone, granite, tiles, HPL, ACP & painted surface
- Exterior Flooring: Combination of Granite, Tiles, Stone & Interlocking tiles
- Lobbies: Combination of stone, tiles, HPL, ACP painted surface
- Unit Finishes: Plastered walls with exposed RCC slabs
- Washroom: Combination of Tiles/ Painted surface on DADO, Stone/Tile Finished Countertops, HPL/Laminated partition door
- Structure: Earthquake resistant RCC structure
- Fire & Life Safety: Provided as per norms.



ATM



Vegetables Store



Convinience Store



Cafeteria



Retail Shops

Images and Photographs shown are an artistic illustration or impression of the project only and are indicative of the aspects of the development and construction.

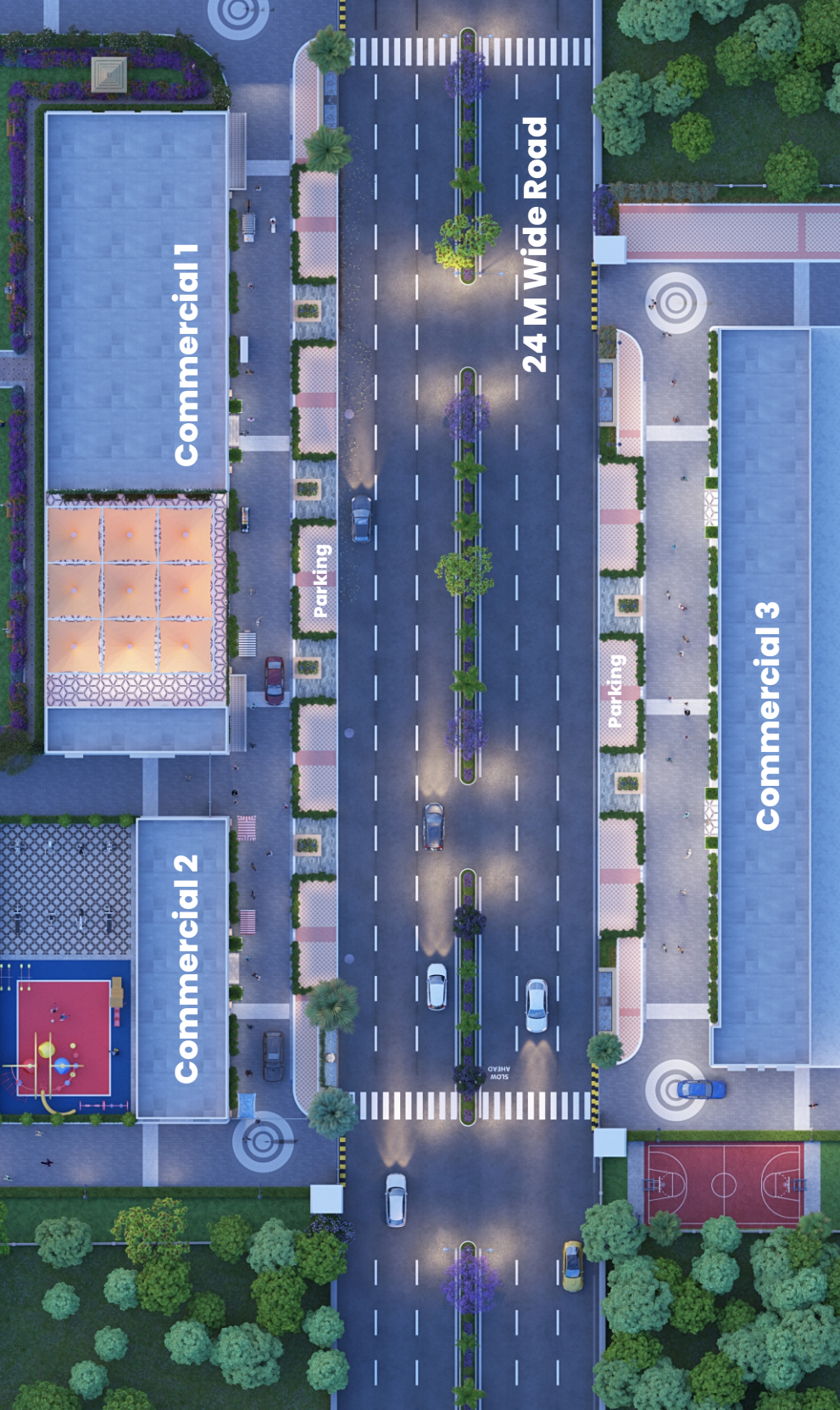

# Live SEAMLESSLY

The special ingredient for a special offering,  
a retail space that is ideally located...

There is no doubt about the fact that in case of the retail/business complex, the location plays the main role. Marked with the presence of most upscale residential projects in the vicinity, shops at Global City Centre 88A are entitled to the lucrative catchment, while enjoying proximity to Dwarka Expressway.

Here are some of the location advantages of Global Heights  
Sector 88A, Gurugram project:

- Proximity to the planned **Metro Station**.
- **Dwarka Expressway** just few meters away( walking distance ).
- **Connected by 3 National Highways:** Delhi-Jaipur Highway (NH 48), Dwarka Expressway(NH 248BB) & Pataudi Road (NH 352W)
- The location is close to Sector 88, a commercial sector occupied by **DLF for Cyber City 2**.
- Emerging as one of the prominent destinations for **IT/ITes companies**.

Key Locations distances in nearby vicinity

- |  |  |
|--|--|
| - Airport   20 minutes                 | - Gurugram ISBT   15 minutes           |
| - Railway Station   06 minutes         | - DPS School   05 minutes              |
| - Cyber Hub   20 minutes               | - Hospitals   15 minutes               |
| - Manesar IMT   10 minutes             | - HUDA City Center   25 minutes        |
| - AIIMS OPD   10 minutes               | - RPS International School   5 minutes |
| - Matrikiran by Vatika School   7 Mins |  |

